



HIGHWAY AT ALTRINCHAM IN THE METROPOLITAN BOROUGH OF TRAFFORD

Playground

Footpath to be stopped up

Track

THE MOUNT

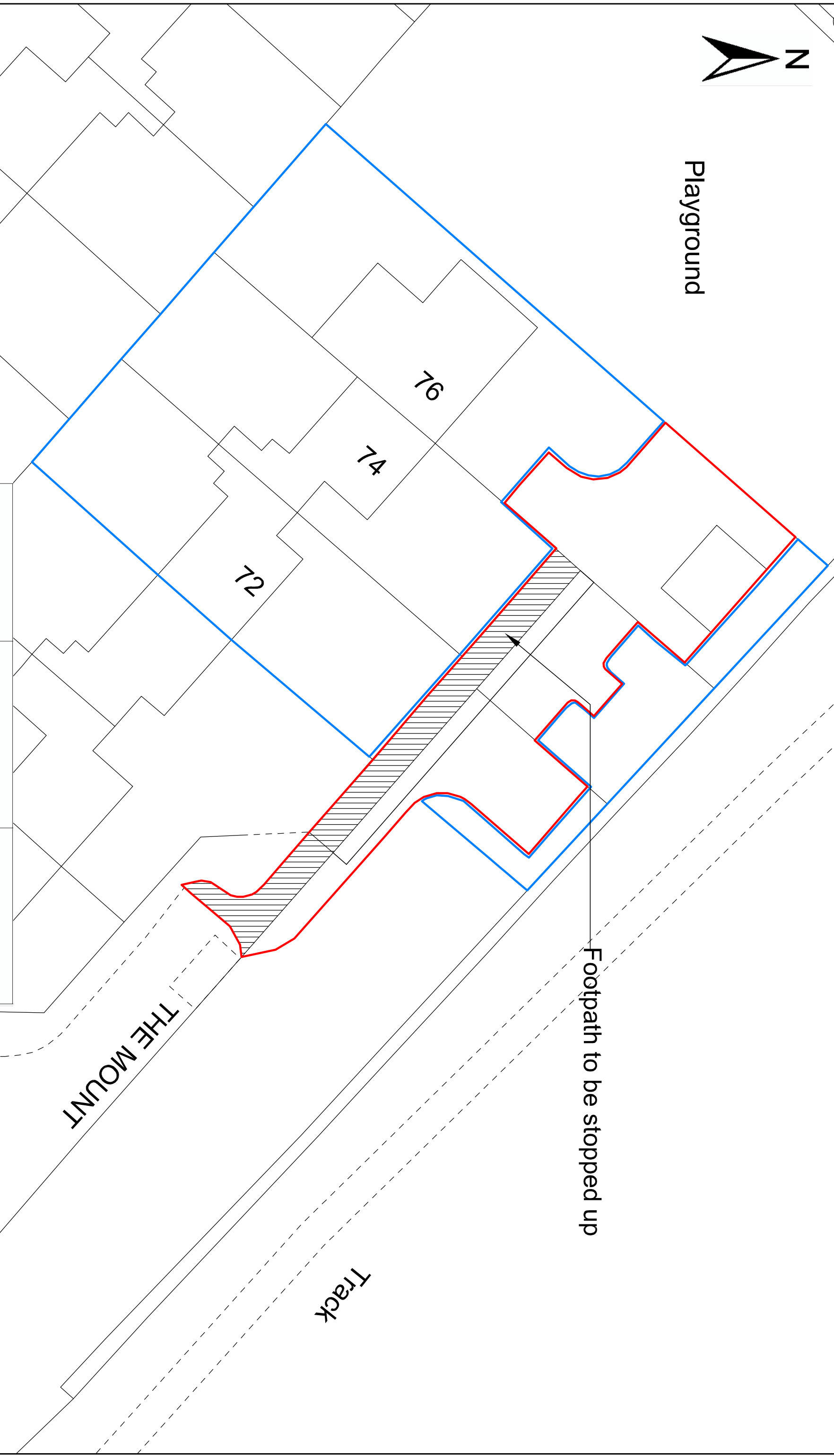

Key Scale 1:250 @ A3  
Highway to be stopped up

National Transport Casework Team  
Department for Transport  
Plan No: NATTRAN/NW/S247/3595

**Plan B**

Signed by Authority of the Secretary of State  
on.....2019  
Signature:.....  
DAVE CANDLISH  
An Official in the  
National Transport Casework Team  
Department for Transport